

# SELECTRO INSTALLATION INSTRUCTIONS

1. Remove existing dustcover (1), split pin (2), castellated nut (3), large washer (4), 6 bolts (5), 6 split washers (6), hub driving member (7) and gasket (8). Discard existing dustcover, split pin, hub drive member and gasket.

2. Set hub to the FREE position. Remove six Allen screws (9) and withdraw the cover and cap assembly (10). Secure hub body (12) using new gasket (8), existing hardware and additional plain washers (11), tighten in opposite pairs. Tighten castellated nut and install NEW split pin. Fit cover and cap assembly to hub body and secure with six Allen screws. Check operation of hubs. Check oil level in Swivel Housing.

3. Affix warning notice to windscreen.

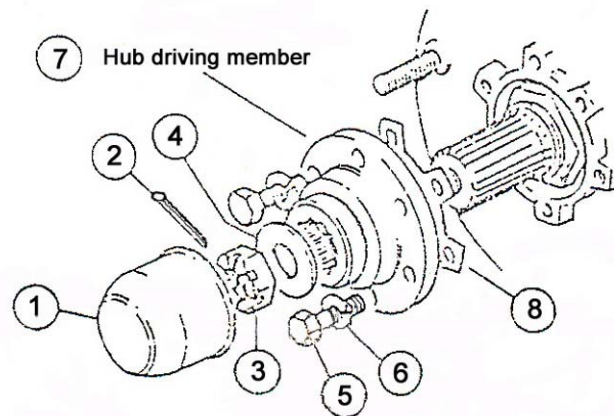

## MAINTENANCE INSTRUCTIONS

1. The vehicle must be operated for at least 1 mile per month in LOCK with hub engaged for proper lubrication of front drive train components.

2. The free wheel hubs should be cleaned, and internal working surfaces thoroughly coated with gear oil at the same time that the wheel bearings are adjusted.

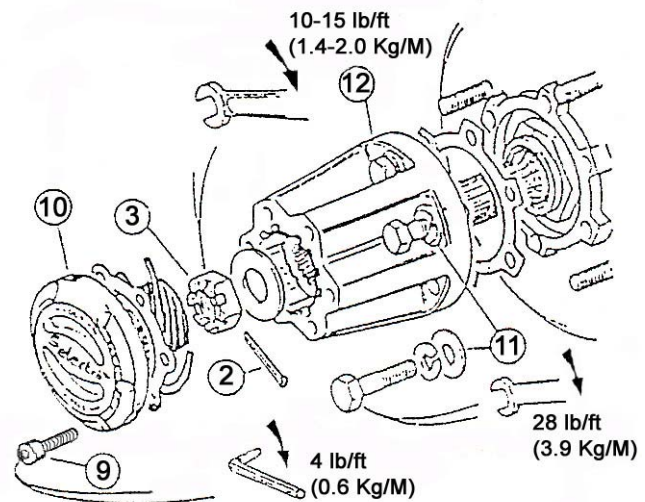

## OPERATING INSTRUCTIONS

### 1. Hubs in LOCK position.

With the hubs in LOCK position, the front wheels are locked to the vehicle transfer case. Four wheel drive high range and low range on the transfer case may be selected in the normal way.

### 2. Hubs in FREE position.

With the hubs in free position, the wheels are isolated from the vehicle transfer case. Only the wheels rotate. The front propshaft, differential and driveshafts will remain stationary.

While the hubs are set in this condition, the maximum benefit in fuel saving will be obtained.

3. ALWAYS check that the hubs are set to LOCK before engaging low range.

If this is not observed, severe damage to transmissions will result.

4. NEVER drive with one hub set to FREE and the other at LOCK. This will cause severe damage to the internal components of the front axle and differential.

5. Use fingers only to turn hub control dial.

## FREE WHEELING HUB KIT

Parts form an assembly or kit (complete for two wheels).

